

Solis
4520

UNVEIL THE FUTURE WITH JAPANESE TECHNOLOGY

POWERFUL E3 ENGINE



ADVANCE EUROPEAN
AERODYNAMIC DESIGN



6 STAGE
COOLING



STYLISH TWIN PROJECTOR
WITH DRL & LED LAMPS



SUPER QUICK POWER
STEERING



MSRPTO
(MULTI SPEED REVERSE PTO)



SUPER STRONG
OIL IMMERSED BRAKE



AUTO TRAILER HITCH



**JAPANESE
TECHNOLOGY**
Expert



www.solistractors.lk

SPECIFICATIONS - 4520

Engine		
Engine HP		47
No. of Cylinders		3
Rated RPM		2100
Max Torque (Nm)		190
Air Cleaner	Dry Air Cleaner With Clogging Sensor	
Transmission		
Clutch Type		Dual Clutch
Gear Box		8F+2R
Max Speed (kmph)		33.6
Brake		
Brake Type		Oil Immersed Brake
Hydraulics		
Lift Capacity (kg)		1600 Kg
3 Point Linkage		CAT II
Hydraulic Control		1DA/1SA
Steering		
Steering		Power
PTO		
PTO Standard RPM		540
MSR PTO		Optional
Tyre		
Tyre	Front	6*16
	Rear	13.6*28
Fuel Tank		
Capacity (L)		55
Dimensions & Weight		
Wheel Base (mm)		2080
Length (mm)		3870
Width (mm)		1815
Front Ballast Weight (Optional)		4*29
Tractor Weight (kg)		2090

*Options Available

*Since product upgradation is a continuous process, specification and details provided are subject to change without any prior intimation.
*Terms and condition apply.

Dealership stamp

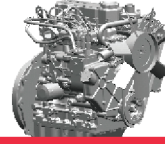

ENGINE

- E3 Engine having Xtra Power, Xtra Torque and Xtra Pickup.
- Efficient Fuel Combustion which results in extra mileage, extra engine life for trouble free operations
- High Engine Torque of 190 Nm

- Easy Swift Shift 8F+2R Gearbox for "Gear Shift on the Go"
- Max Speed of 33.6 Kmph for better productivity
- Optimized speed for better productivity in Rotavator
- Maintenance free transmission which saves time and money
- Tough transmission for Tough Haulage

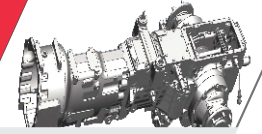

NEXT GENERATION TRANSMISSION

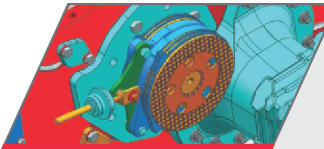

SUPER STRONG OIB

- Most Efficient braking in Tough Haulage
- Provides Longer Brakes Life due to multiple Discs
- Super Strong Brakes provides safety in hills

- Offers Highest PTO Power which gives better pulverization, Achieves 540 in 1680 ERPM which results in fuel saving
- Optional reverse PTO ensures dechoking of Rotavator, ensures easy operations and saves time

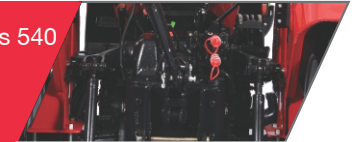

PTO



STYLING

- Advance European Aerodynamic Design
- Aerodynamic Sloping hood design ensures better visibility
- Stylish twin projector with DRL & LED lamps



INTERNATIONAL TRACTORS LIMITED

International Business Office: Teri School of Advanced Studies, Plot No.10, Institutional Area, Vasant Kunj, New Delhi-110070 (India)
Phone: +91 11 66 45 5200 | Work: Jalandhar Road, Hoshiarpur - 146022, Punjab (India) | Phone: +91-01882-522220/ 522221
Fax:+91- 01882-522222 | URL: www.solistractors.lk